



## Installing your Z-Finder Adhesive Mounting Frame

- 1 Peel paper film off the back of Adhesive Mounting Frame



If using a Canon T2i you must modify the adhesive backing to protect the proximity sensors

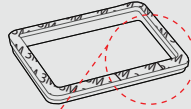

- 2 Center on LCD and apply pressure with book or similar for 24 hours until cured

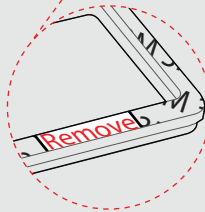
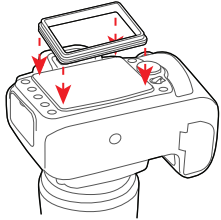

Remove the pre-cut piece of film and rub adhesive off with finger. Remove rest of film and install frame as normal

- 3 Snap Z-Finder Pro onto frame

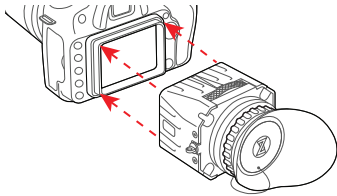

## Installing your Z-Finder Adhesive Mounting Frame

- 1 Peel paper film off the back of Adhesive Mounting Frame

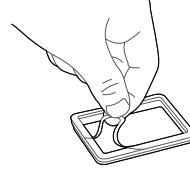

If using a Canon T2i you must modify the adhesive backing to protect the proximity sensors

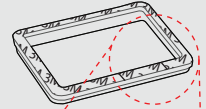

- 2 Center on LCD and apply pressure with book or similar for 24 hours until cured

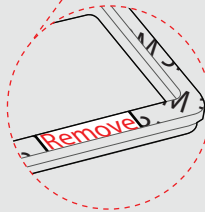
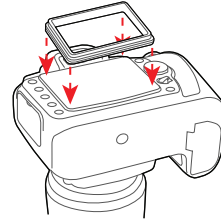

Remove the pre-cut piece of film and rub adhesive off with finger. Remove rest of film and install frame as normal

- 3 Snap Z-Finder Pro onto frame

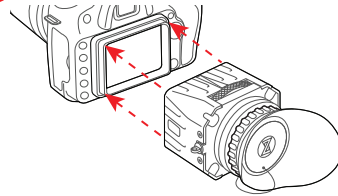

## Installing your Z-Finder Adhesive Mounting Frame

- 1 Peel paper film off the back of Adhesive Mounting Frame



If using a Canon T2i you must modify the adhesive backing to protect the proximity sensors

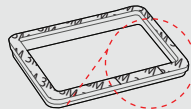

- 2 Center on LCD and apply pressure with book or similar for 24 hours until cured

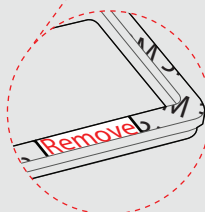
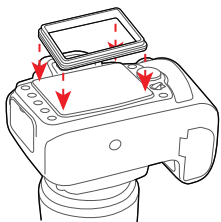

Remove the pre-cut piece of film and rub adhesive off with finger. Remove rest of film and install frame as normal

- 3 Snap Z-Finder Pro onto frame

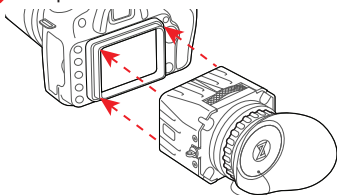

## Installing your Z-Finder Adhesive Mounting Frame

- 1 Peel paper film off the back of Adhesive Mounting Frame



If using a Canon T2i you must modify the adhesive backing to protect the proximity sensors

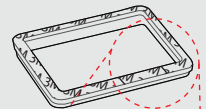

- 2 Center on LCD and apply pressure with book or similar for 24 hours until cured

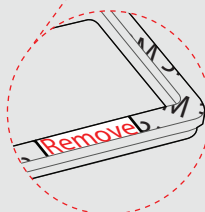
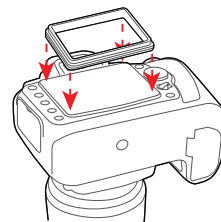

Remove the pre-cut piece of film and rub adhesive off with finger. Remove rest of film and install frame as normal

- 3 Snap Z-Finder Pro onto frame

